



# 832 Eglinton Avenue E

10,365 SF of Available Space Across Two Floors



**Lennard:**

200-55 University Avenue, Toronto  
416.649.5920

\*Broker

**Trevor Ellis\***

Senior Vice President

905.247.9229 • [tellis@lennard.com](mailto:tellis@lennard.com)

**Brian Heming**

Sales Representative

416.915.5685 • [bheming@lennard.com](mailto:bheming@lennard.com)



# 832 Eglinton Avenue E

## Property Highlights

- Prime location in Laird/Eglinton Node, North York
- Directly along new Crosstown LRT, adjacent to upcoming Laird Station
- Multi-level space with freight elevator servicing all floors
- Ample parking behind building and along street front

## Building Features

- Private offices along back wall
- Open kitchen area
- Power: 200 amps, 600 volts, 3 phase 3 watts
- Rooftop HVAC system
- Air Conditioning and security system
- Bus Line & Metro/Subway
- Signage
- Wheelchair Accessible
- Mezzanine



Available Space

Main Level: 3,360 SF

Mezzanine Level: 3,000 SF

Lower Mezzanine Level: 3,000 SF

Basement: 1,000 SF



Parking

9 Parking Spaces



Net Rent

Contact Broker

Additional Rent

\$8.34 PSF (2023 Est.)



Zoning

CR2.1 ((C0.7;r1.1)\*298)



Availability

Vacant



Clear Height

Main Floor: 18'

Upper Mezzanine Floor: 12'

Lower Mezzanine Floor: ~10'



Loading

Building backs onto a lane and has a loading door at ground level



# Nearby Retail Traffic Drivers

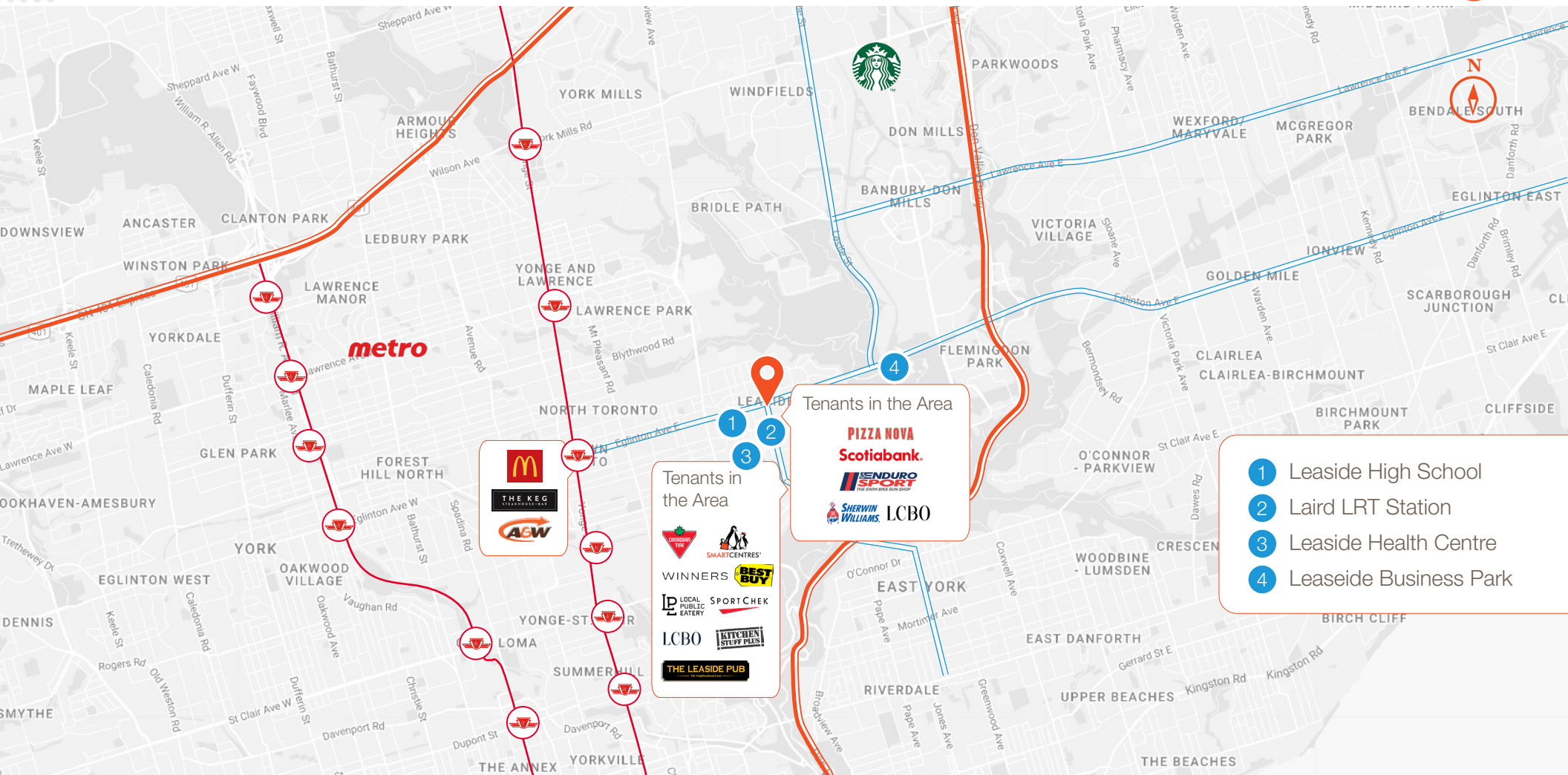

832 Eglinton Avenue E

Bus Route

Subway Line



TTC Subway Stations

Highways



# New Developments

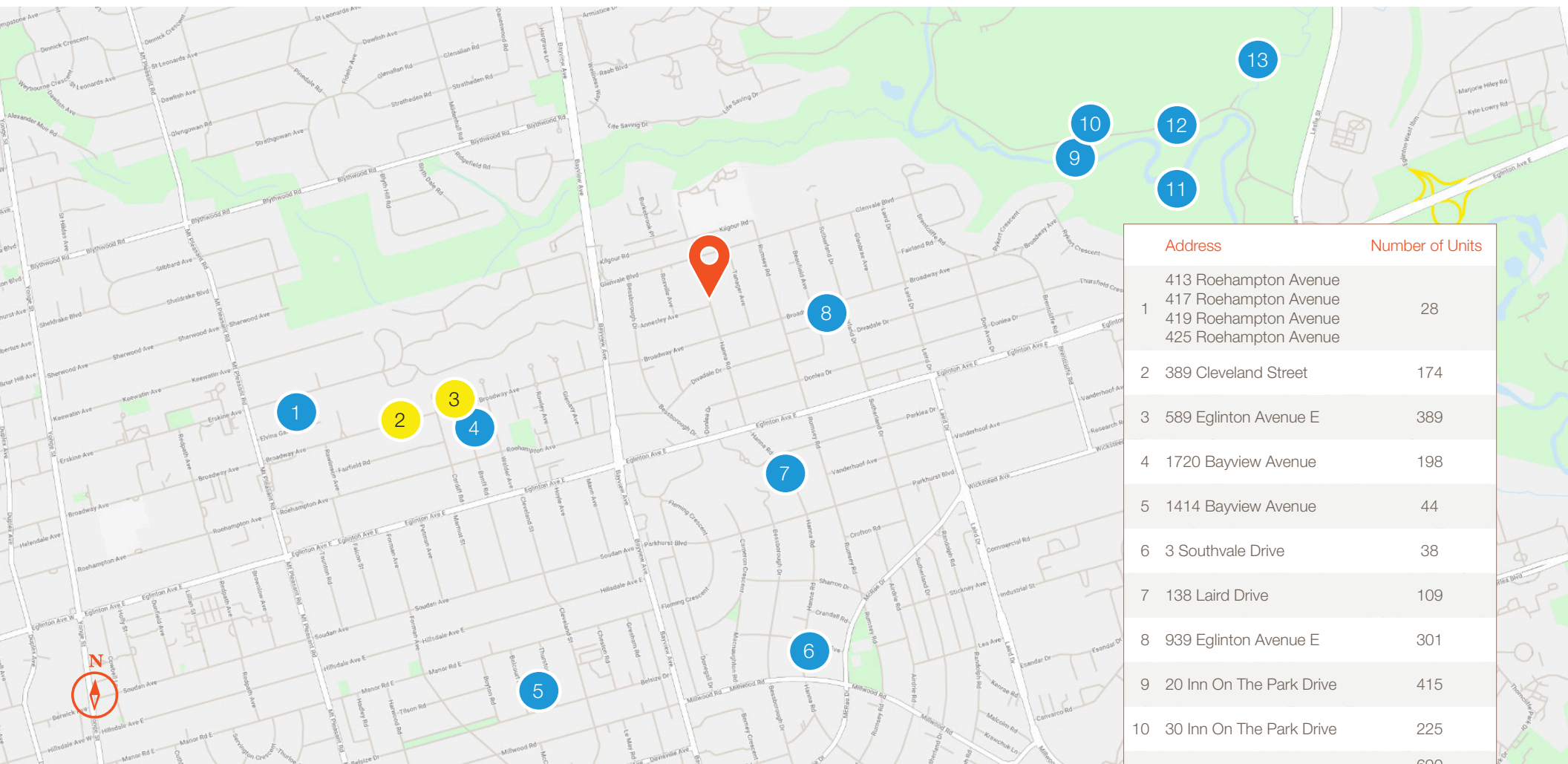

832 Eglinton Ave E



Active



Coming Soon

|    | Address  | Number of Units |
|----|--|-----------------|
| 1  | 413 Roehampton Avenue<br>417 Roehampton Avenue<br>419 Roehampton Avenue<br>425 Roehampton Avenue | 28              |
| 2  | 389 Cleveland Street   | 174             |
| 3  | 589 Eglinton Avenue E  | 389             |
| 4  | 1720 Bayview Avenue  | 198             |
| 5  | 1414 Bayview Avenue  | 44              |
| 6  | 3 Southvale Drive  | 38              |
| 7  | 138 Laird Drive  | 109             |
| 8  | 939 Eglinton Avenue E  | 301             |
| 9  | 20 Inn On The Park Drive   | 415             |
| 10 | 30 Inn On The Park Drive   | 225             |
| 11 | 1155 Eglinton Avenue E   | 690             |
| 12 | 1150 Eglinton Avenue E   | 191             |
| 13 | 844 Don Mills Road   | 308             |
|    |  | 377             |
|    |  | 379             |



# Demographics

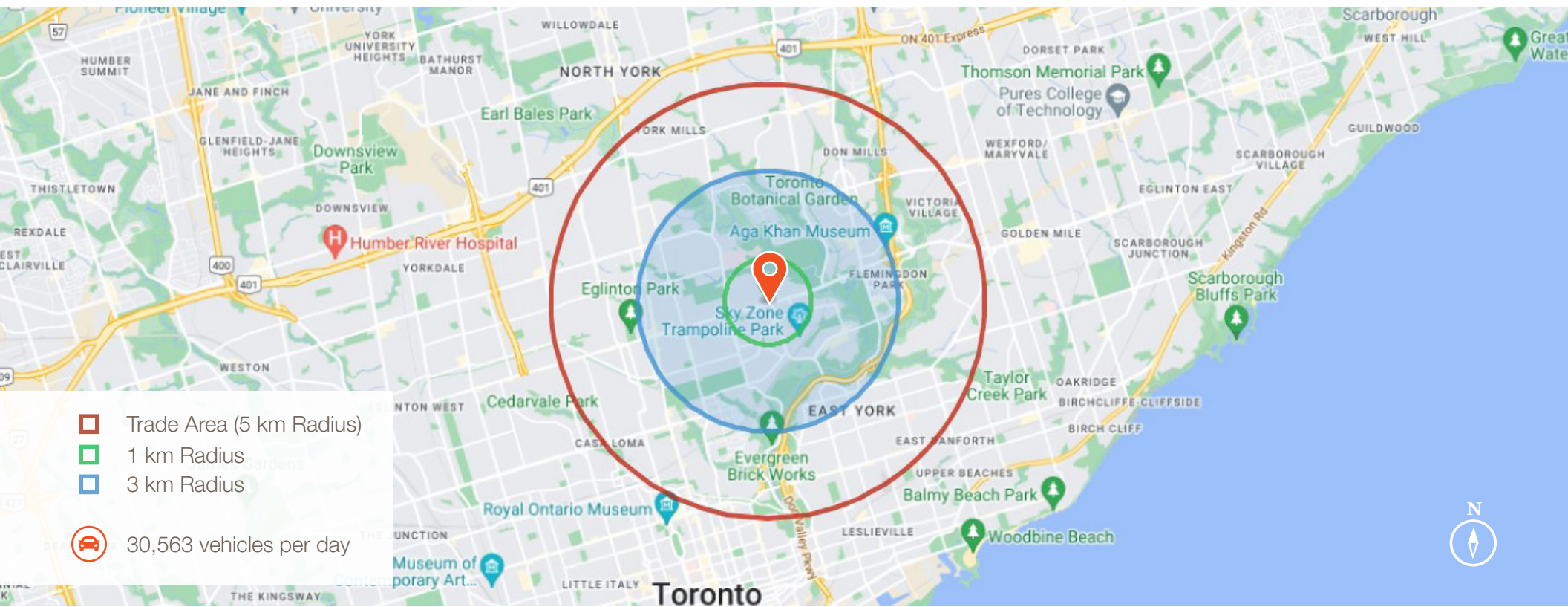

| Criteria                       | Aggregation | Trade Area (5 km Radius) | 1 km Radius  | 3 km Radius  |
|--------------------------------|-------------|--------------------------|--------------|--------------|
| Total Population               | Sum         | 384,358                  | 11,075       | 142,913      |
| Total Daytime Population       | Sum         | 409,771                  | 13,890       | 168,264      |
| Avg. Household Income          | Average     | 180,357                  | 241,094      | 159,600      |
| Average Age                    | Average     | 42                       | 42           | 41           |
| Avg. Annual Household Spending | Average     | \$156,690.95             | \$209,444.70 | \$138,648.48 |



# 832 Eglinton Avenue E

Floorplan: Lower Level

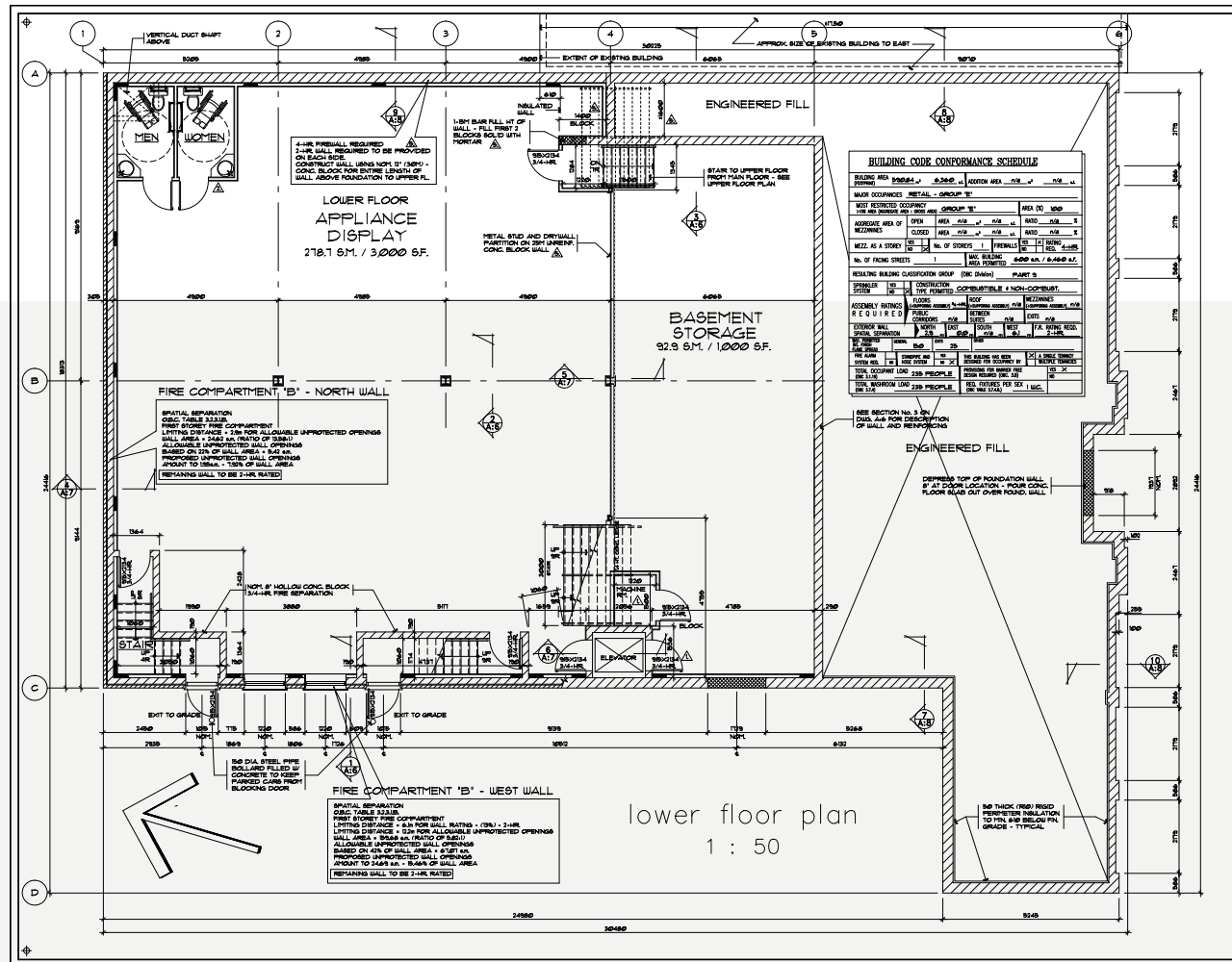



# 832 Eglinton Avenue E

Floor Plan: Main/Upper Level

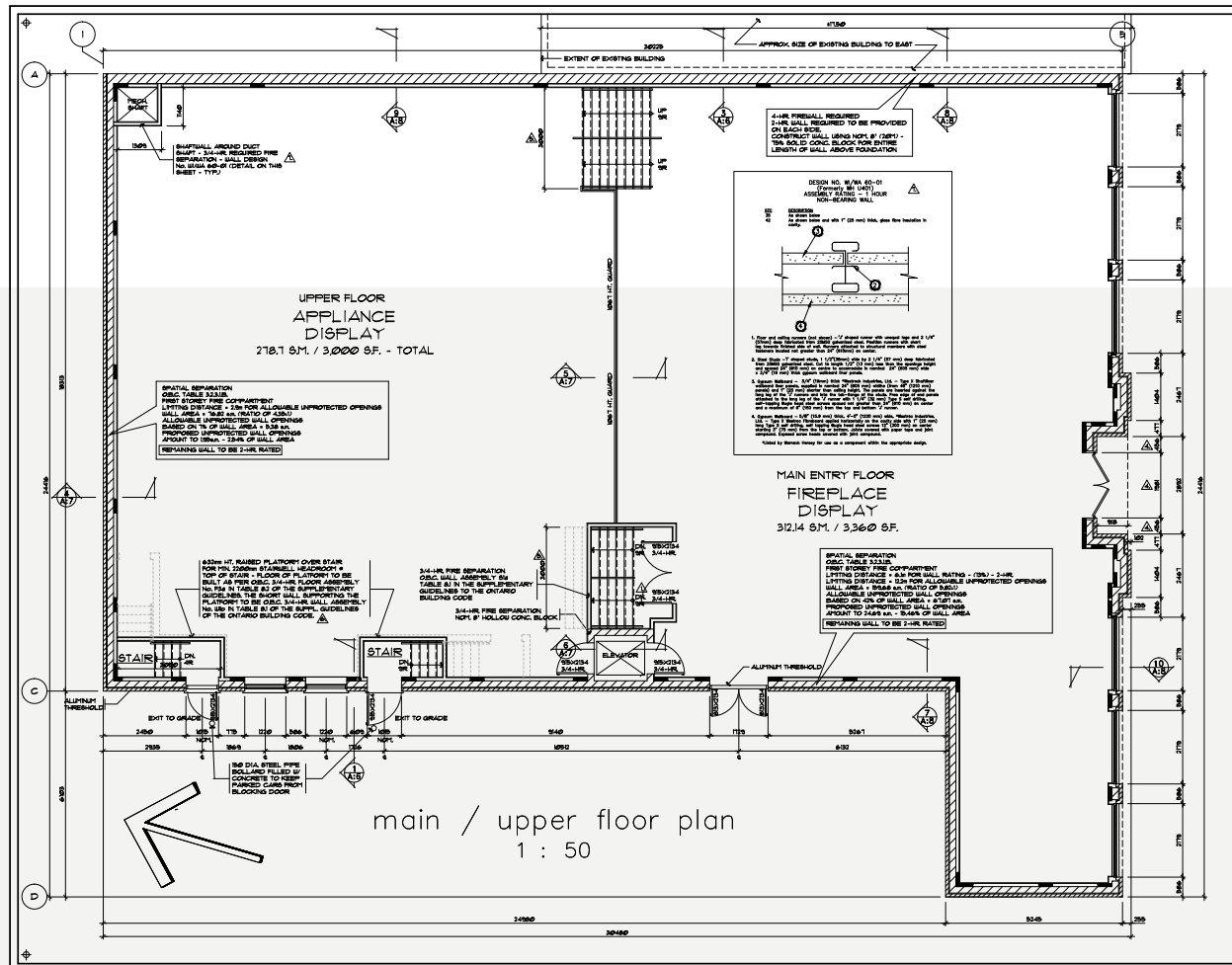



# 832 Eglinton Avenue E

## Traffic Counts

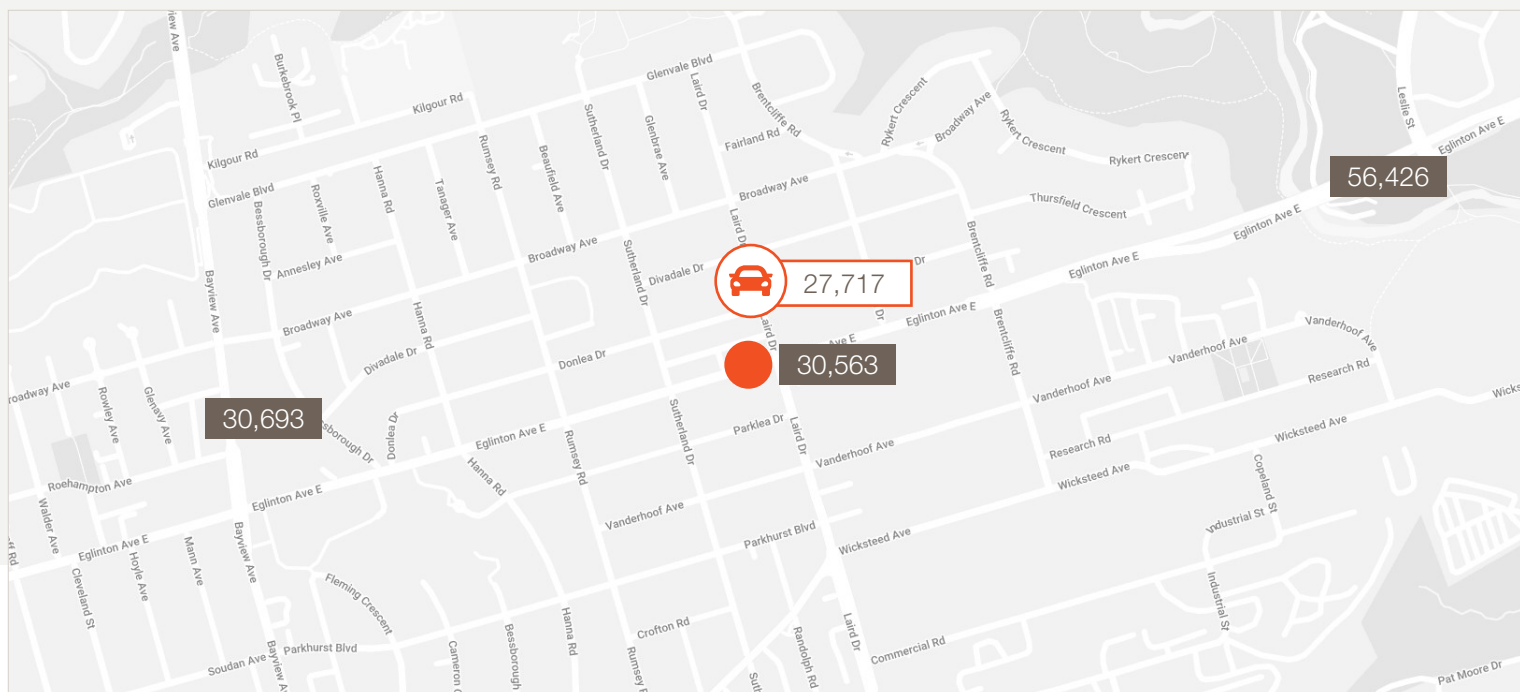

| Intersection  | Count Date     | 8 Peak hour Vehicle Volume | 8 Peak Hour Pedestrian Volume |
|---|----------------|----------------------------|-------------------------------|
| Eglinton Avenue E / Bayview Avenue  | Oct 21st 2014  | 30,693                     | 4,920                         |
| Eglinton Avenue E / Laird Drive   | Jan 28th, 2016 | 30,563                     | 2,881                         |
| Eglinton Avenue E / Leslie Street   | Oct 10th 2013  | 56,426                     | 401                           |
|  Eglinton Avenue E & Laird Drive Average Vehicle Volume per day (2023): 27,717 |                |                            |                               |



# Gallery





## Retail Space For Sublease



# Retail Expertise, Street *Wise* Performance

200-55 University Avenue, Toronto  
416.649.5920

Statements and information contained are based on the information furnished by principals and sources which we deem reliable but for which we can assume no responsibility. Lennard Commercial Realty, Brokerage.

416.915.5685 • [bheming@lennard.com](mailto:bheming@lennard.com)