

665 Taunton Road E

1.37 Acres of Residential Infill Lands in Whitby

Glenn Crosby**, Sr VP
905.695.9170
gcrosby@lennard.com

Aran Pope*, VP
905.695.9172
apope@lennard.com

Brennan Shier*
905.695.9258
bshier@lennard.com

For Sale: Development Land



Site Plan
Approved
& Serviced
Lands

Lennard:

201-60 Columbia Way, Markham
905.752.2220 • lennard.com

*Sales Representative **Broker

665 Taunton Road E

Site plan approved for 24 common element freehold townhouses in Whitby



Size

1.37 acres

Total Units

24 Townhouses

Frontage on Taunton Road

316 feet

Lot Depth

187.4 feet (irregular)

Services

**Full municipal servicing
to the lot line**

Designation

**Medium Density
Residential**

(Within the Thickson / Taunton
Community Central Area
Secondary Plan)



Asking Price

3,950,000



Listing Agents

Glenn Crosby**

Senior Vice President

905.695.9170

gcrosby@lennard.com

Aran Pope*

Vice President

905.695.9172

apope@lennard.com

Brennan Shier*

905.695.9258

bshier@lennard.com

Property Highlights

- Fully serviced to the lot line
- In close proximity to several schools and the University of Ontario Institute of Technology
- Several amenities in the near vicinity
- Numerous new home developments in the area

665 Taunton Road E

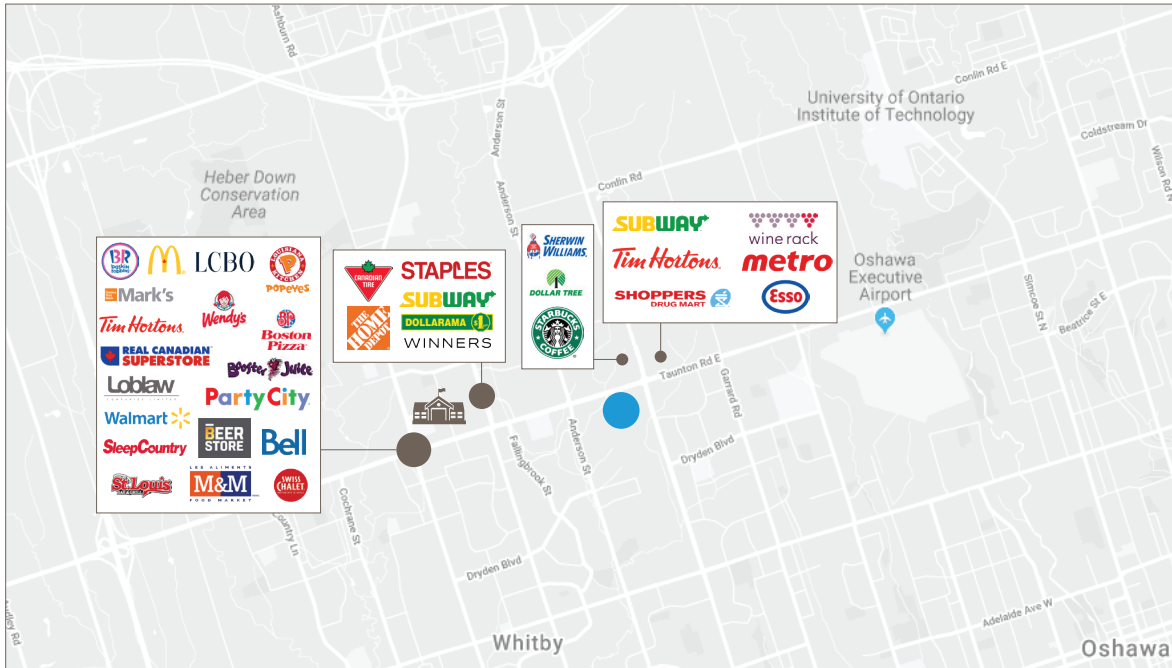

● Subject Property 🏠 2 Secondary Schools

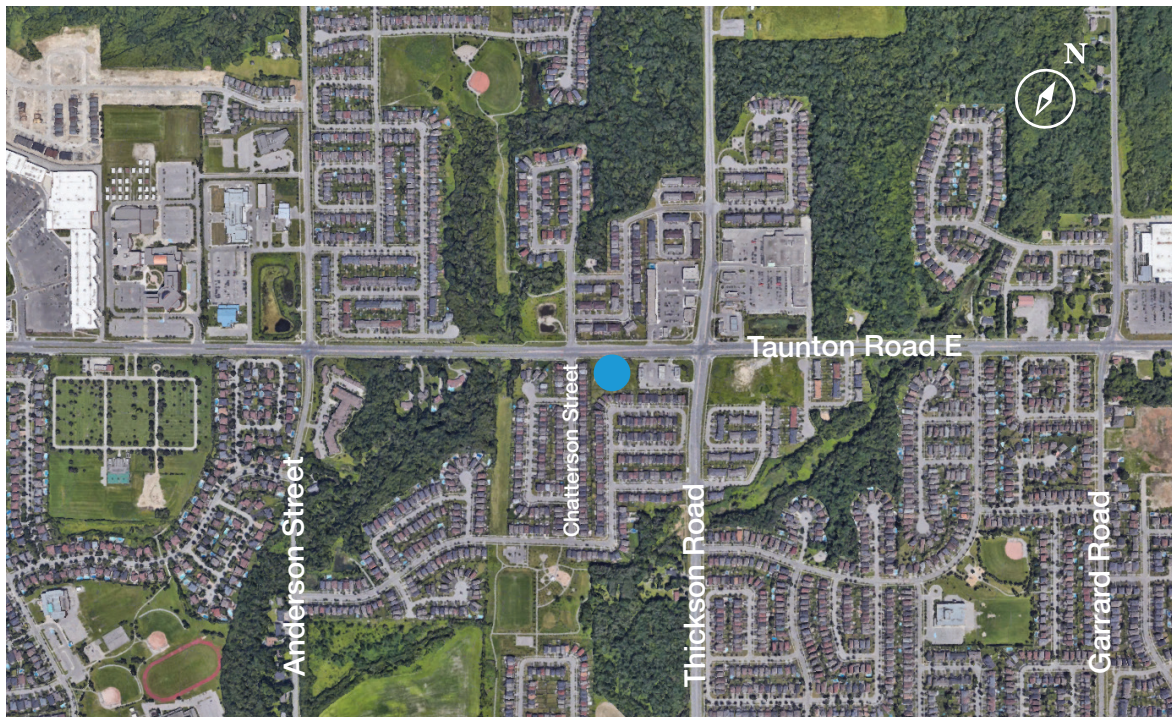

Statements and information contained are based on the information furnished by principals and sources which we deem reliable but for which we can assume no responsibility. Lennard Commercial Realty, Brokerage 2019.

665 Taunton Road E

Site Plan

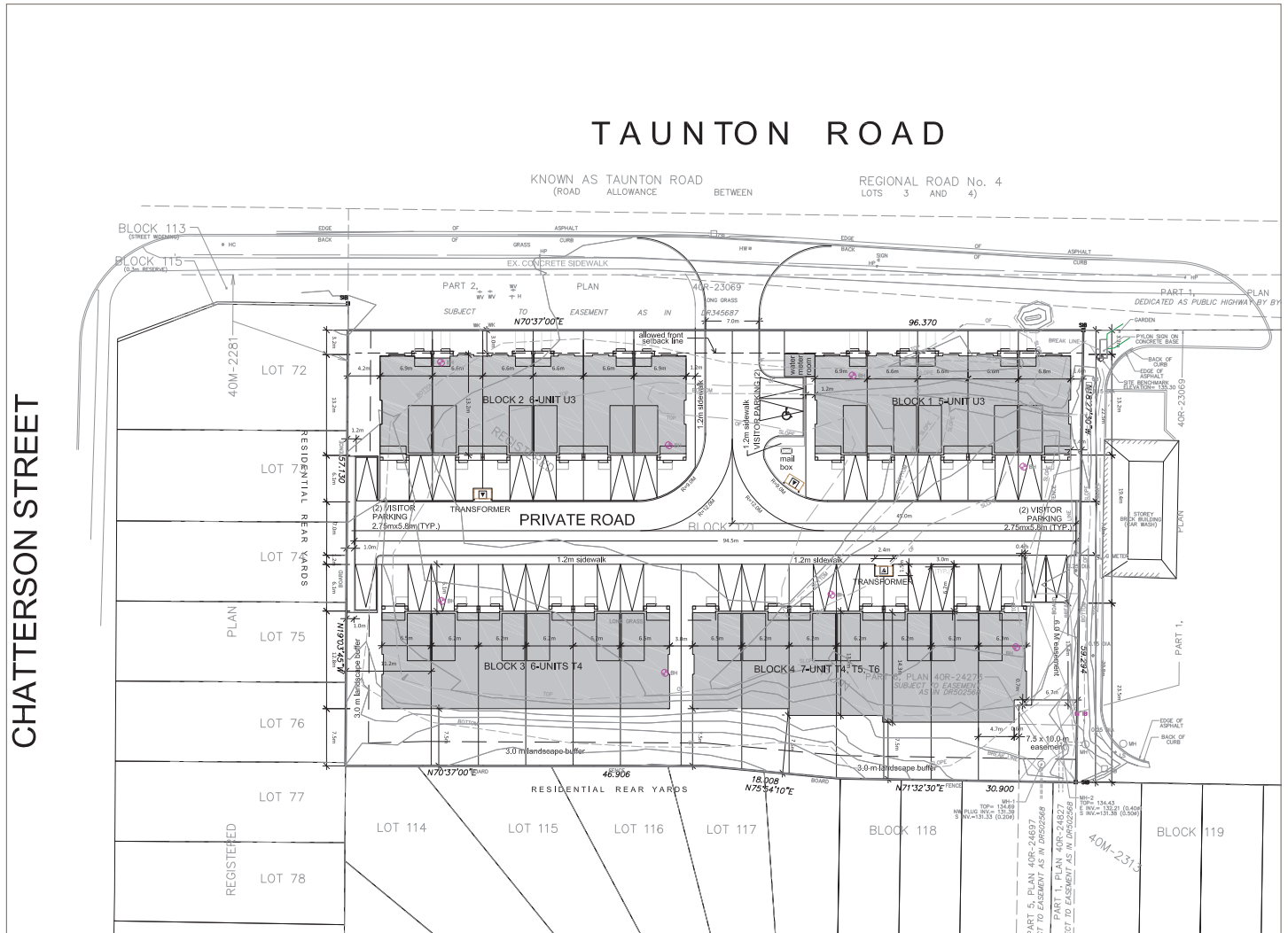

Site Statistics

Total Site Area

1.37 ac

Townhouse Units:

24 Total (11 Urban Townhomes; 13 Regular Townhomes)

Parking Provided:

54 Total (Including 6 Visitor Spaces)

Lennard:

lennard.com

665 Taunton Road E

Thickson/Taunton Community Central Area Secondary Plan

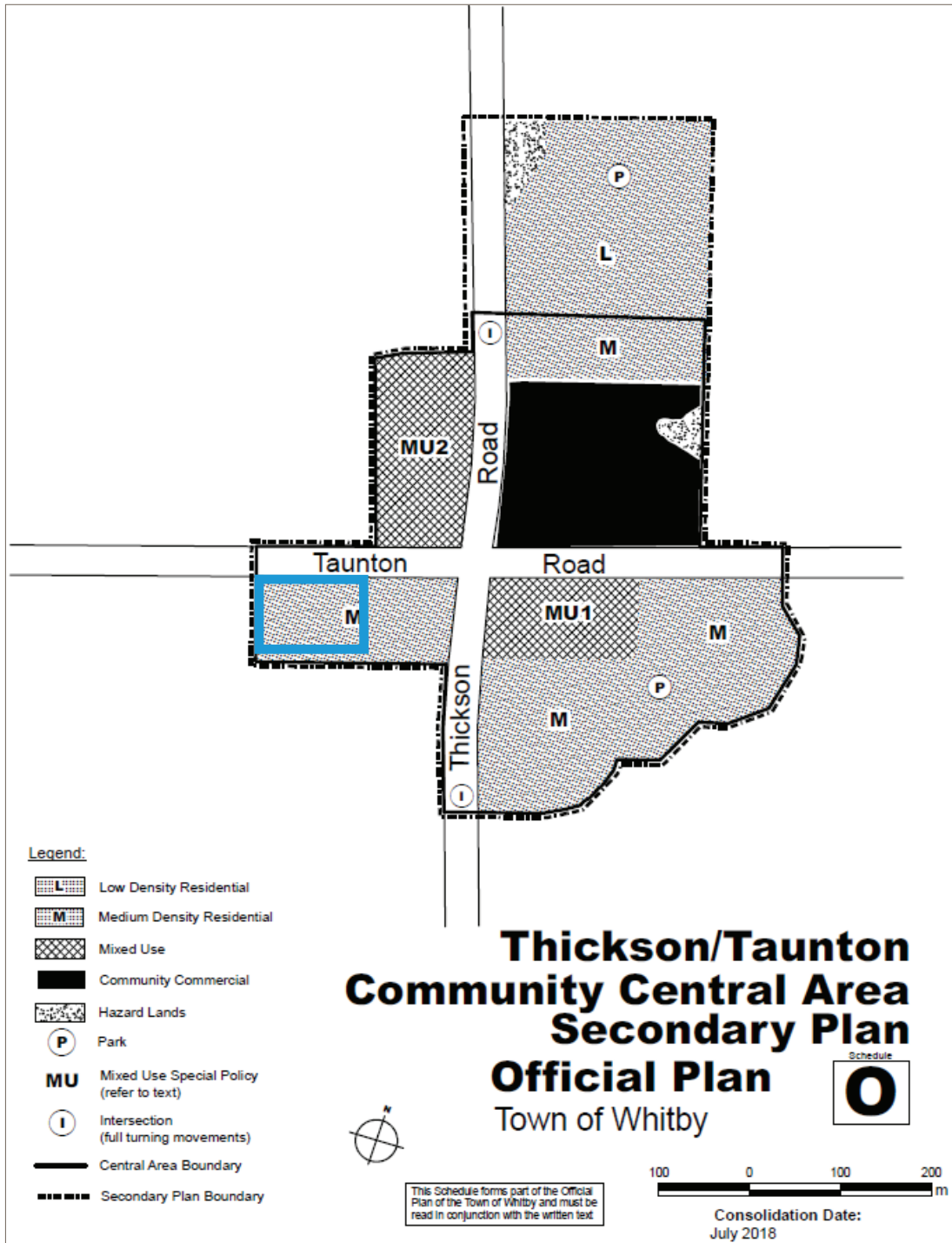

Note: Outlines are approximate.