



For Lease: Industrial

1960 Ellesmere Road

Rare 5,000 SF Industrial Unit in Established Industrial Node

Lennard:

201-60 Columbia Way
905.752.2220

lennard.com

1960 Ellesmere Road

5,000 SF industrial unit for lease at Ellesmere Road and Markham Road, just south of Highway 401 in Scarborough



Unit 4

5,000 SF

Office Space

15%

Industrial Space

85%



Net Rent

\$16.95 PSF

Additional Rent

\$3.75 PSF



Shipping

1 Truck Level



Clear Height

14'



Power

600 Volts, 200 Amps



Marty Atkins**

Vice President

416.565.3455

matkins@lennard.com

**Broker

Property Highlights

- Excellent exposure fronting onto major street
- Good access to Highway 401
- Lots of windows
- Good location for wholesale, showroom, manufacturing, fabrication and warehousing
- TTC accessible
- No religious, automotive or food uses permitted

1960 Ellesmere Road

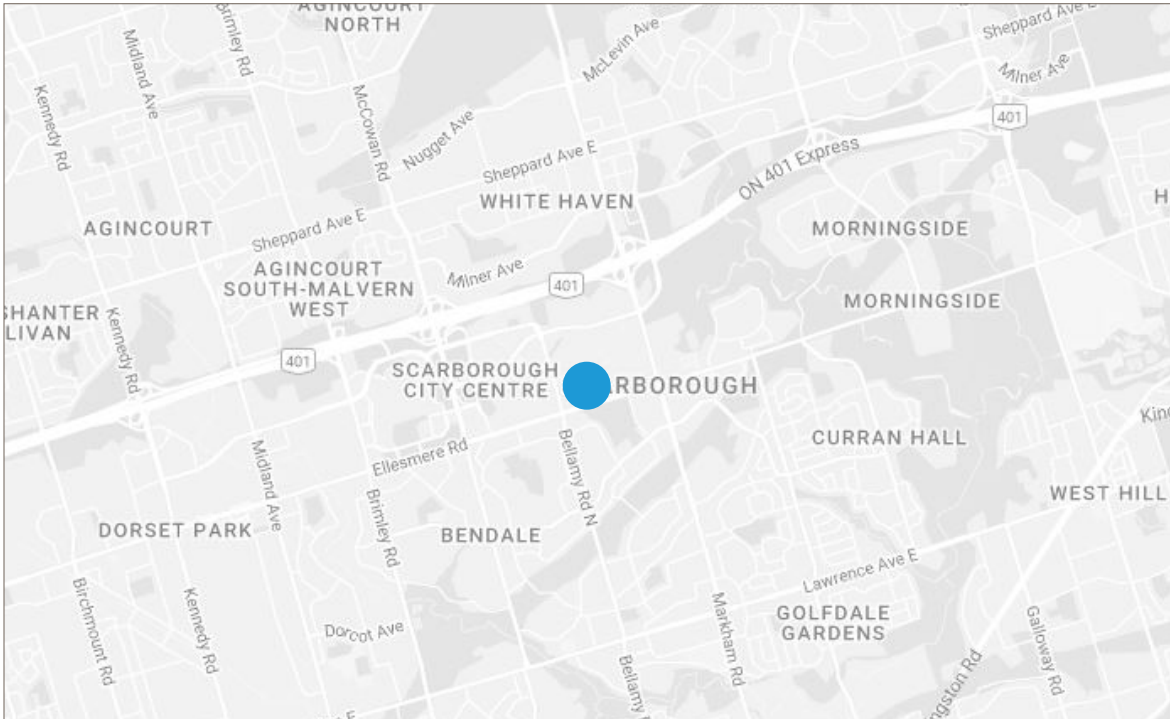

1960 Ellesmere Road

Unit 4

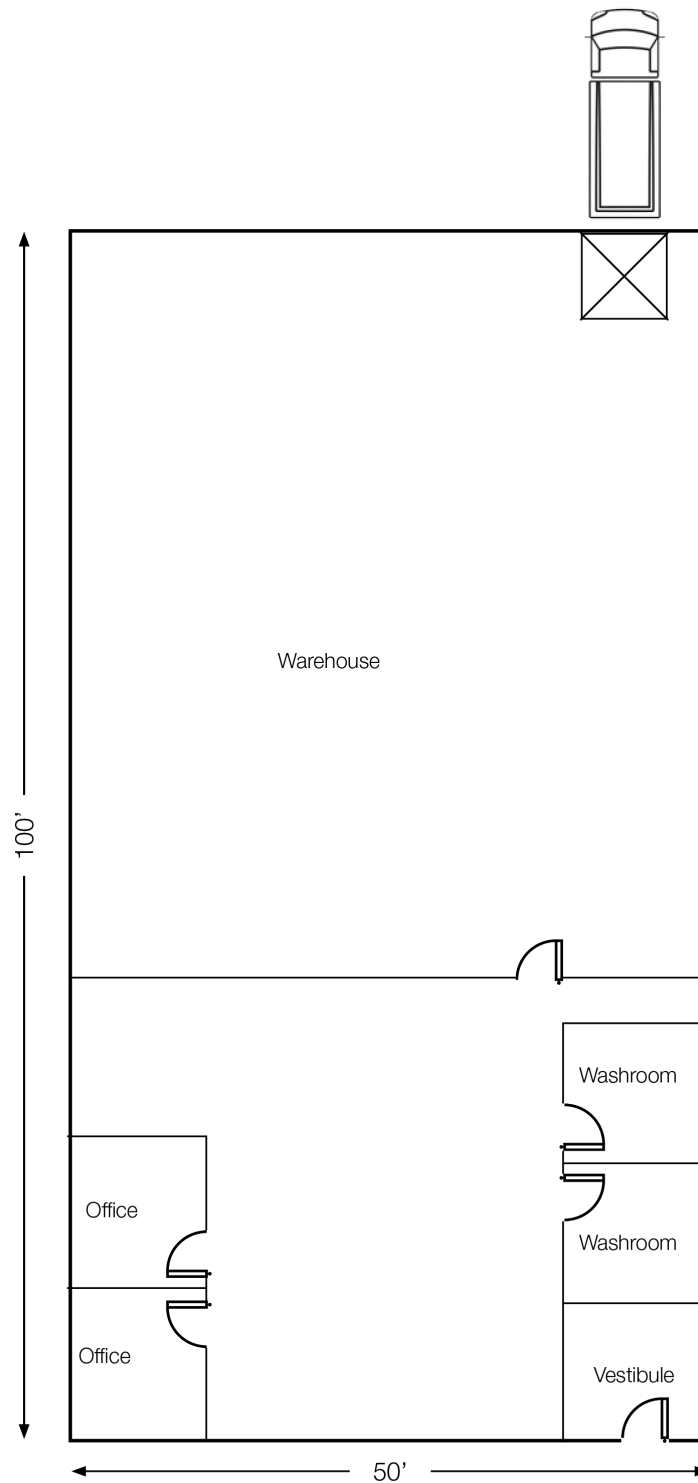

Note: Drawing may not be to scale

Lennard:

Marty Atkins**, Vice President
416.565.3455 • matkins@lennard.com

**Broker

lennard.com

Lennard:

Marty Atkins**, Vice President
416.565.3455
matkins@lennard.com

201-60 Columbia Way, Markham
905.752.2220
lennard.com

**Broker

Statements and information contained are based on the information furnished by principals and sources which we deem reliable but for which we can assume no responsibility. Lennard Commercial Realty, Brokerage.