

# 12599 Highway 50

Bolton, Ontario

Sasha Ischenko\*  
905.917.2032  
sasha@lennard.com

For Lease: Retail



Here is where  
your business  
will *grow*.

**Lennard:**

201-60 Columbia Way, Markham  
905.752.2220 • [lennard.com](http://lennard.com)

\*Sales Representative

# 12599 Highway 50

Retail plaza centrally located along Bolton's main retail corridor



Unit 5A  
**796 SF**



Leasing Agent

**Sasha Ischenko**

Sales Representative

905.917.2032

sasha@lennard.com



Net Rent

**\$18.00 PSF**

Additional Rent

**\$8.00 PSF**

Includes Water



Term

**3 to 10 years**

## Floor Plan

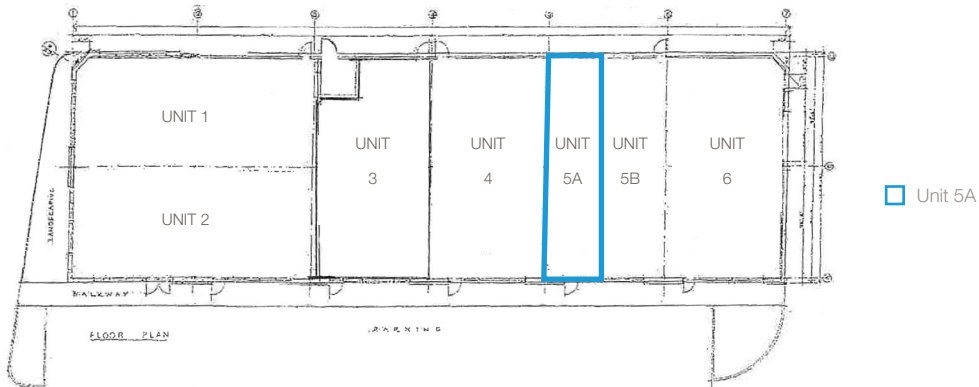

# 12599 Highway 50



## Property Highlights

- Immediate occupancy
- Units are suitable for multiple retail uses
- Excellent exposure along Highway 50, a major north south roadway providing access from Bolton and areas north to the GTA
- Located along Bolton's main retail corridor, just south of McEwan Drive W
- Steps from national retailers such as Walmart, CanadianTire, LCBO and many more
- Close proximity to the residential communities of Bolton West, South Bolton Village and Downtown Bolton

## Demographics

	2 KM	3 KM	5 km
Population:	7,255	13,418	28,491
2016 Households:	2,282	4,394	9,206
2016 Median HH Income:	\$91,629	\$96,859	\$103,856

## Traffic Counts

Collection Street	Cross Street	Volume
Highway 50	Simona Drive	28,126
Highway 50	Parr Boulevard	24,093
Highway 50	Side Road 5	28,830

Statements and information contained are based on the information furnished by principals and sources which we deem reliable but for which we can assume no responsibility. Lennard Commercial Realty, Brokerage 2019.

**Lennard:** Sasha Ischenko, Sales Representative  
905.917.2032 • sasha@lennard.com

[lennard.com](http://lennard.com)